

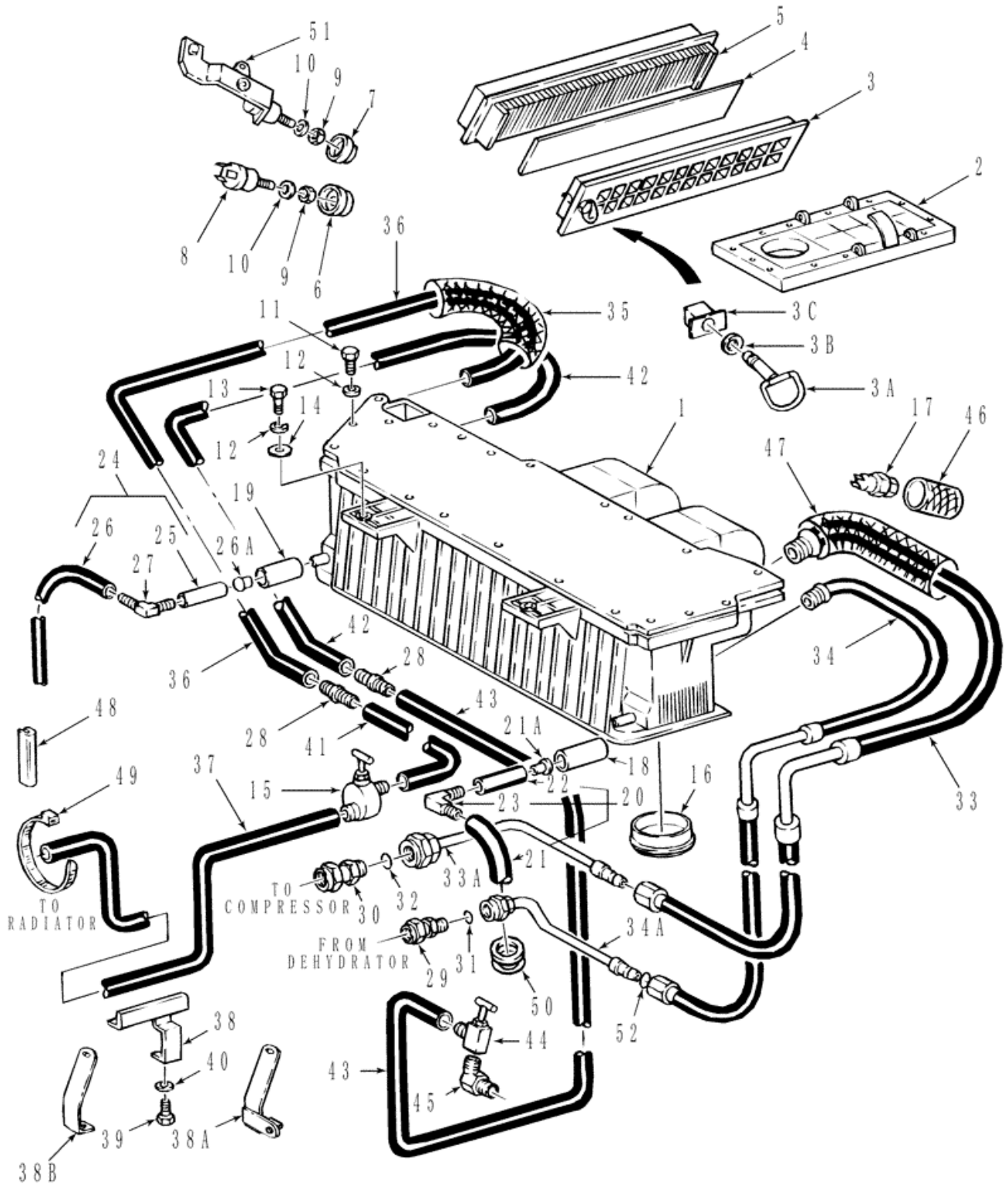

PARTS & MERCHANDISE  
STORE

New Holland Agriculture 621 State Street  
NACustomerRelations@newholland.com Racine, Wisconsin 53404  
866-639-4563 option 1

(8340) - 6 CYL AG TRACTOR 40 SERIES (11/91-7/98) > (15E01) - HEATER, AIR CONDITIONER,





PARTS & MERCHANDISE  
STORE

**New Holland Agriculture 621 State Street**  
**NACustomerRelations@newholland.com Racine, Wisconsin 53404**  
**866-639-4563 option 1**

(8340) - 6 CYL AG TRACTOR 40 SERIES (11/91-7/98) > (15E01) - HEATER, AIR CONDITIONER,

Diag #	Part #	Name	Description	Qty
1	NS	NOT SERVICED	Heater/Air Conditioner Assy., Refer to Fig. 15E03, Years: 01-NOV-91-31-MAR-94	1
2	81871630	AERATOR	Ventilator, LH, Years: 01-NOV-91-31-MAR-94	1
2	81871632	FAN	Ventilator, RH, Years: 01-NOV-91-31-MAR-94	1
3	81871634	SUPPORT	Fresh Air Filter, Includes: Ref. 3A	2
3A	81875580	STUD	Stud, Years: 01-NOV-91-31-MAR-94	2
3B	F0NN94549N07BA	RETAINER,6mm ID x 12.5mm OD x 0.5mm Thk	, Years: 01-NOV-91-31-MAR-94	4
3	83994515	SPRING CLIP	In Roof, Years: 01-NOV-91-31-MAR-94	2
4	82033107	AIR FILTER	Filter, Intake Primary, Years: 01-NOV-91-31-MAR-94	2
5	F0NN18N385AB	FILTER	Intake, Years: 01-NOV-91-31-MAR-94	2
5	82014790	CAB FILTER	Filter, Intake, Start Year: 01-APR-97	2
6	81867241	KNOB	A/C, Years: 01-NOV-91-31-MAR-94	1
7	81867238	KNOB	Blower	2
8	D5NN15122A	SWITCH	Heater Blower, Years: 01-NOV-91-31-MAR-94	1
9	274562	THIN NUT	Jam, 7/16"-28, Years: 01-NOV-91-31-MAR-94	1
10	9715503	LOCK WASHER,Ext Tooth, 7/16"	Washer, Lock, Ext T, 7/16", Years: 01-NOV-91-31-MAR-94	1
11	43118	BOLT,Hex, M6 x 1.0 x 40mm, Cl 8.8	, Years: 01-NOV-91-31-MAR-94	2
12	86517328	LOCK WASHER,6.1mm ID x 11.8mm OD x 1.7mm Thk	Washer, Lock, M6, Years: 01-NOV-91-31-MAR-94	1
13	120100	BOLT,M6 x 20mm, Cl 8.8	, Years: 01-NOV-91-31-MAR-94	2
14	9824259	WASHER,6.4mm ID x 12mm OD x 1.6mm Thk	M6, Years: 01-NOV-91-31-MAR-94	2
15	83985127	HYDRAULIC VALVE	Valve, Heater (Replaces E9NN18495AA), Years: 01-NOV-91-31-MAR-94	1
16	83994728	VENT	ilator, Defrost, Years: 01-NOV-91-31-MAR-94	4
17	83998913	SWITCH ASSY	Switch, A/C Clutch Cycle, Years: 01-NOV-91-31-MAR-94	1
18	83994831	FITTING	Connector, OD 13mm, Years: 01-NOV-91-31-MAR-94	2
19	83994832	FITTING	Connector, OD 9mm, Years: 01-NOV-91-31-MAR-94	2
20	NS	NOT SERVICED	Tube Assy., A/C Drain, Includes: Ref. 21 thru 23, Years: 01-NOV-91-31-MAR-94	2

Diag #	Part #	Name	Description	Qty
21	83994822	A/C HOSE,829.00 mm	829.00 mm, Years: 01-NOV-91-31-MAR-94	2
21A	9832204	RIVET	Tubular, 10mm x 20mm, Years: 01-NOV-91-31-MAR-94	1
22	83994825	TUBE,10.00 mm ID x 543.00 mm	10.00 mm ID x 543.00 mm, Years: 01-NOV-91-31-MAR-94	2
23	83994807	ELBOW	, Years: 01-NOV-91-31-MAR-94	2
24	NS	NOT SERVICED	Tube Assy., A/C Drain, Includes: Ref. 25 thru 27	2
25	83994816	A/C HOSE,6.00 mm ID x 255.00 mm	HOSE 6.00 mm ID x 255.00 mm, Years: 01-NOV-91-31-MAR-94	2
26	82011448	FLEXIBLE HOSE,6.00 mm ID x 1685.00 mm	6.00 mm ID x 1685.00 mm, Years: 01-NOV-91-31-MAR-94	2
26A	9832278	RIVET	Tubular, 6mm x 20mm, Years: 01-NOV-91-31-MAR-94	1
27	83994810	ELBOW	, Years: 01-NOV-91-31-MAR-94	2
28	83954537	FITTING	Connector, Heater Hose, Years: 01-NOV-91-31-MAR-94	2
28	82010788	HYD CONNECTOR	Connector, Elbow, Heater Hose, Start Year: 01-OCT-96	1
29	D5NN19B596A	COUPLING	Self-Sealing, A/C, Years: 01-NOV-91-31-MAR-94	1
30	1280492C1	PUSH-PULL COUPLING	Coupler, Self-Sealing A/C, 1-1/4", Years: 01-NOV-91-31-MAR-94	1
31	122056	O-RING,0.07" Thk x 0.676" ID, -17, CI 5, 75 Duro	.676" ID x .070" Thk, Years: 01-NOV-91-31-MAR-94	1
32	129740	O-RING,0.07" Thk x 1.051" ID, -23, CI 5, 75 Duro	1.051" ID x .070" Thk, Years: 01-NOV-91-31-MAR-94	1
33	82005606	FLEXIBLE HOSE,16 mm OD, 56.7, 77 mm Length	Tube, Evaporator to Compressor, Use W/ 82007132 Adptr., Years: 01-NOV-91-31-MAR-94	1
33A	82000936	TUBE,15.88 mm OD, 170.2, 73.3 mm Length	Evaporator to Compressor, Years: 01-NOV-91-31-MAR-94	1
34	82005607	FLEXIBLE HOSE,10 mm OD	Tube, Dehydrator to Evaporator, Years: 01-NOV-91-31-MAR-94	1
34A	82000935	TUBE,9.525" Diameter	Dehydrator to Evaporator, Includes Ref. 52, Years: 01-NOV-91-31-MAR-94	1
35	E4NN18482AA	GUARD	Heater Hose, Years: 01-NOV-91-31-MAR-94	1
36	83994769	RADIATOR HOSE,15.25 mm ID	Heater to Radiator 15.25 mm ID, Years: 01-NOV-91-31-MAR-94	1
37	82010785	HEATER HOSE,15.25 mm ID	Heater to Radiator 15.25 mm ID, Years: 01-NOV-91-28-FEB-93	1
37	82010785	HEATER HOSE,15.25 mm ID	Heater to Radiator 15.25 mm ID, Start Year: 01-MAR-93	1
37	82010785	HEATER HOSE,15.25 mm ID	Heater to Radiator 15.25 mm ID, Start Year: 01-OCT-96	1
38	F0NN18481BB	BRACKET	, Years: 01-NOV-91-28-FEB-93	1

Diag #	Part #	Name	Description	Qty
		Replaced by Reference 38A & 38B	Replaced by Reference 38A & 38B	1
38A	F2NN18481BA	BRACKET	, Years: 01-MAR-93-31-MAR-94	1
38B	81878530	BRACKET	, Years: 01-MAR-93-31-MAR-94	1
39	304703S36	SCREW	Cap, HH, G5, 3/8"-16 x 1-1/8", Years: 01-NOV-91-31-MAR-94	2
40	80680	LOCK WASHER,3/8 0.381 CST ZND	WASHER, LOCK, 3/8", Years: 01-NOV-91-31-MAR-94	2
41	82010787	HEATER HOSE,15.25 mm ID	FLEXIBLE HOSE, 15.25 mm ID, Years: 01-NOV-91-31-MAR-94	1
41	82010787	HEATER HOSE,15.25 mm ID	FLEXIBLE HOSE, 15.25 mm ID, Start Year: 01-OCT-96	1
42	F0NN18N400BB	HOSE	, Years: 01-NOV-91-28-FEB-93, Serial Range: Engine-Heater	1
42	F0NN18N400BB	HOSE	, Years: 01-MAR-93-31-MAR-94, Serial Range: Engine-Heater	1
43	82020609	HEATER HOSE,15.25 mm ID, 600.00 mm	, Years: 01-NOV-91-31-MAR-94	1
44	83961305	VALVE	Valve, Years: 01-NOV-91-31-MAR-94	1
45	387127S	ELBOW,9/16" - 18 ORFS x 13/16" - 16 ORFS	, Years: 01-NOV-91-31-MAR-94	1
46	81871638	FOAM INSULATION	Insulation, A/C Switch, Years: 01-NOV-91-31-MAR-94	1
47	F1NN19911AA	TUBE,22 mm ID x 40 mm OD x 350 mm L	Insulation, A/C Tube, Years: 01-NOV-91-31-MAR-94	1
48	E8NN8N197AA	MOLDING	Moulding, Years: 01-NOV-91-31-MAR-94	1
49	263117	CABLE TIE,292.1mm L	Strap, Cable, .14 x 11 1/2" L, Years: 01-NOV-91-31-MAR-94	1
50	370211S	GROMMET	, Years: 01-NOV-91-31-MAR-94	2
51	REFERENCE	SPARE PART	Control Assy., See Fig. 15E03, Ref. 29, Start Year: 01-NOV-91	1
52	82000734	SEAL	O-Ring, 5/16" ID x .07" Thk, Years: 01-NOV-91-01-MAR-94	2